

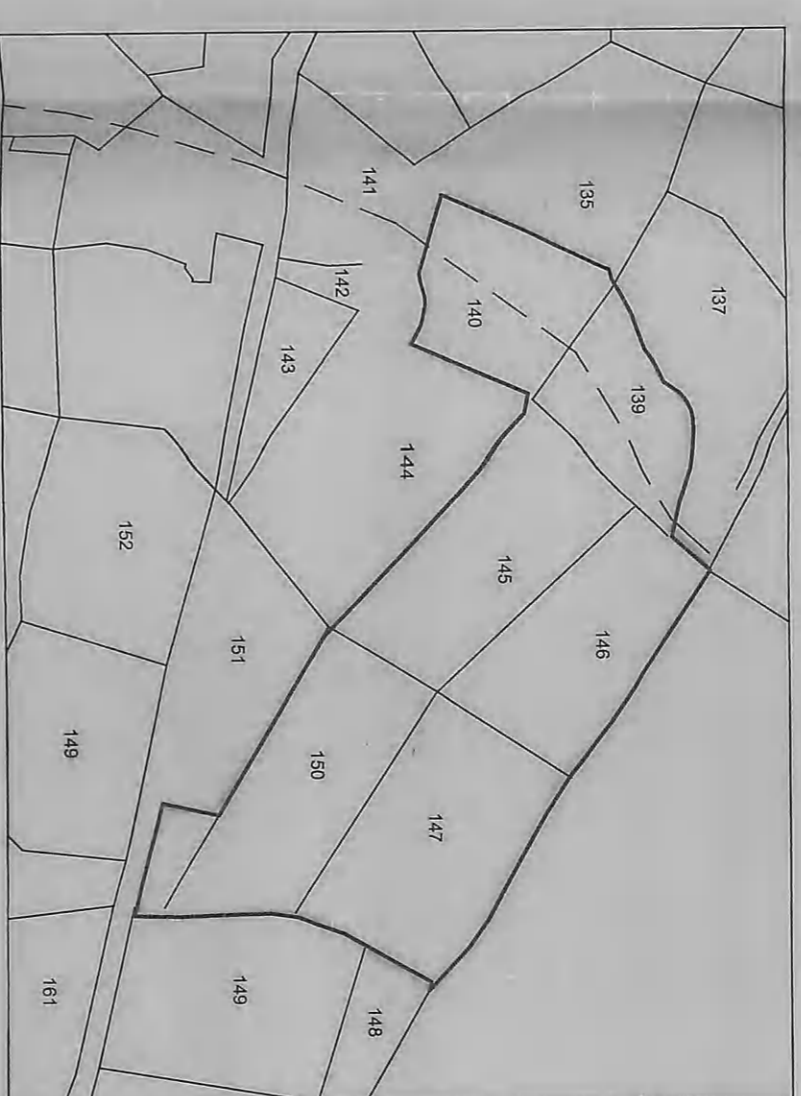

CAUTION -  
 THIS IS A LEGALLY VALID ONLY ON ITS RELEASE APPROVAL  
 BY CONCERNED MUNICIPALITY UNDER SECTION 194 & 195 OF  
 THE ACTS 1956 ON FULL FULFILLMENT OF ALL LAI/UT CONDITIONS  
 AND ANY TRANSACTIONS PRIOR TO THE ABOVE IS ILLEGAL.

EXTRACT OF SOLIPUR VILLAGE MAP  
 SITE QR



- REFERENCE
- LAI/UT BOUNDARY
  - PROPOSED ROADS
  - TOTAL LAI/UT AREA
  - SITE RESERVE FOR PUBLIC PURPOSE (PARK) (10.00%)
  - ROADS RESERVE AREA (5.25%)
  - PRIMARY SCHOOL AREA
  - NURSERY SCHOOL AREA
  - AMENITIES BLOCK AREA
  - CONVENIENT STORES
- AC 88.825  
 AC 8.38  
 AC 0.82  
 AC 1.53  
 AC 1.52  
 514 (648+67)



EXISTING 30m ROAD TO BE WIDENED TO 60m WIDE ROAD AS PER METROPOLITAN DEVELOPMENT PLAN  
 TO BANGLORE  
 TO HYDRABAD

**SHADNAGAR MUNICIPALITY**  
 TECHNICAL LAYOUT PATTERN FOR RESIDENTIAL PLOTS IN SY. NOS. 139, 140, 145/P, 145, 146, 147/P, 150 & 151 OF SOLIPUR VILLAGE, FAROOQ NAGAR WANDAL, SHADNAGAR MUNICIPALITY, MAHABUBNAGAR DISTRICT.  
 SCALE : - 1 INCH TO 100 FEET

APPROVED BY:  
 SUPERVISOR: *[Signature]*  
 ASST. DIRECTOR: *[Signature]*  
 DEPT. T.L. DIRECTOR: *[Signature]*  
 JOINT DIRECTOR (R.E.): *[Signature]*  
 DIRECTOR OF TOWN AND COUNTRY PLANNING: *[Signature]*  
 STATE ENGINEER (R.E.): *[Signature]*