

C.NO. 2734 / 2014 / H

REF. No. G/713/2013 - 14, DT.27-03-2014,
OF M.C., VIKARABAD.

T.L.P. No. 60 /2014/H



CAUTION :-

THIS LAYOUT IS LEGALLY VALID ONLY ON ITS RELEASE/APPROVAL
BY CONCERNED MUNICIPALITY UNDER SECTION 184 & 185 OF
A.P.M.ACT.1965.ON FULL FILLMENT OF ALL LAYOUT CONDITIONS,
AND ANY TRANSACTION PRIOR TO THE ABOVE IS ILLEGAL

EXTRACT OF VIKARABAD MASTER PLAN
SITE UNDER REFERENCE :

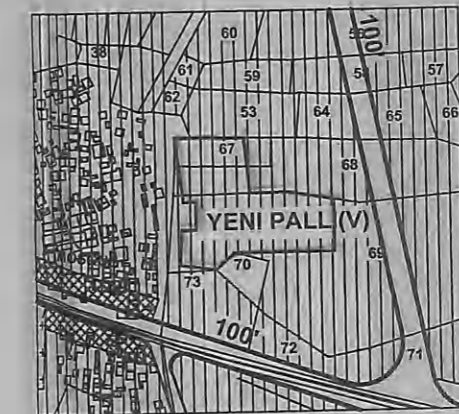

SCALE : NOT TO SCALE

REFERENCE

- LAYOUT BOUNDARY
- EXISTING ROADS
- PROPOSED ROADS
- LAND TO BE DISPOSED

TOTAL LAYOUT AREA : AC. 7.45 CENTS

AREA RESERVED FOR PUBLIC
PURPOSE (PARK) (10.00%) : AC. 0.745 CENTS

ROADS AREA (31.14%) : AC. 2.34 CENTS

TOTAL NUMBER OF PLOTS : 86

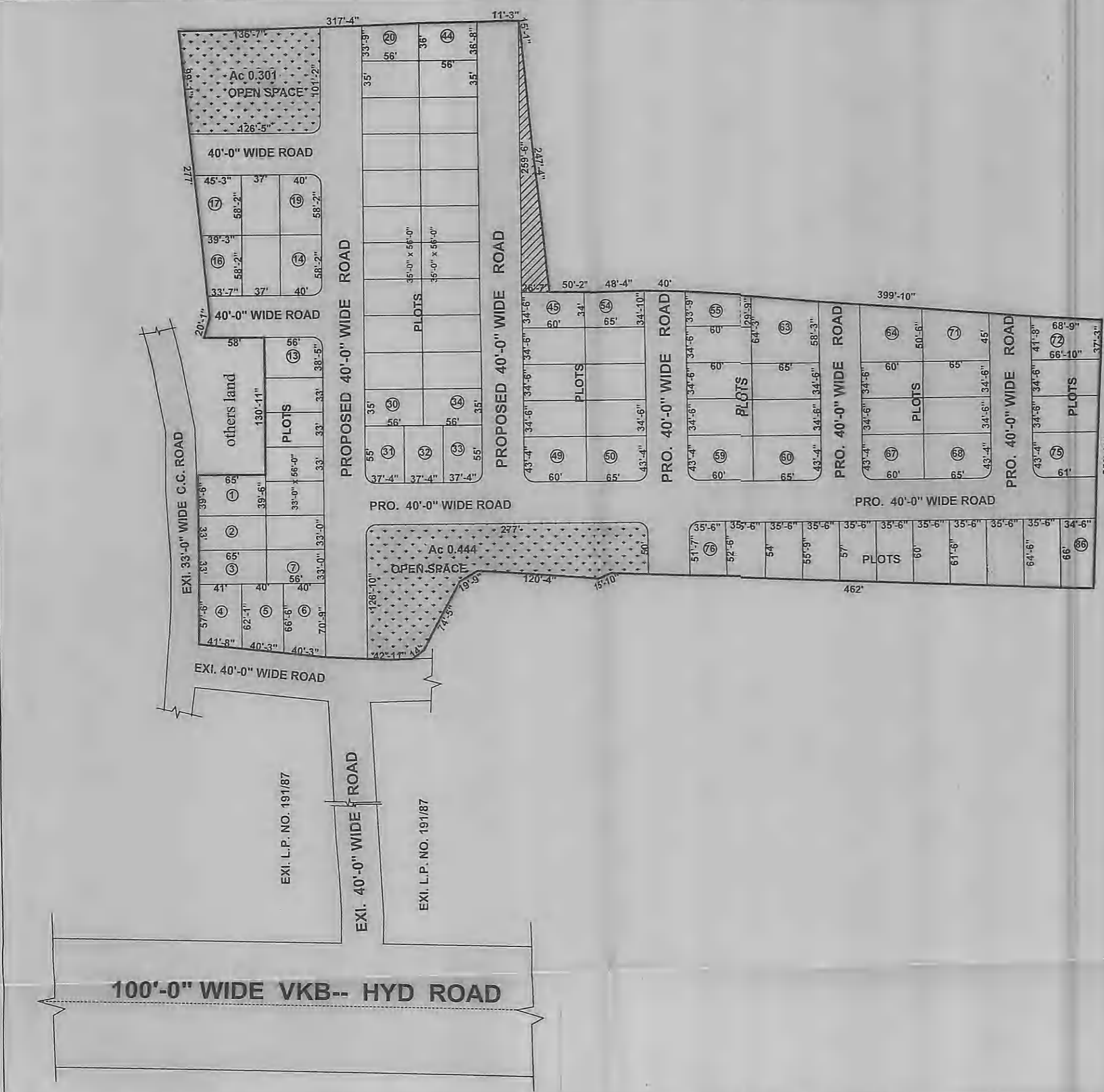

VIKARABAD MUNICIPALITY

TECHNICAL LAYOUT PATTERN FOR RESIDENTIAL PLOTS IN
SY.NOs.67/Part, 68/Part & 69/Part OF YENNEPALLY VILLAGE,
VIKARABAD MUNICIPALITY, RANGAREDDY DISTRICT.

SCALE : 1" = 100'

 ASST. DIRECTOR	 DEPUTY DIRECTOR	 JOINT DIRECTOR (RE.)	 DIRECTOR OF TOWN AND COUNTRY PLANNING GOVT. OF ANDHRA PRADESH, HYDERABAD.
 SURVEYOR			