

C. No. :- 5383 / 2013 / H

REF. No. :- 731 / 2013 / HRO / H1, DT.28-03-2014 OF
RDDTP, HYDERABAD.

CONFIRMED T.L.P. NO. 53 / 2014/H



CAUTION :-
THIS LAYOUT IS LEGALLY VALID ONLY ON ITS RELEASE/APPROVAL
BY CONCERNED MUNICIPALITY UNDER SECTION 184 & 185 OF
A.P.M.ACT 1986 ON FULL FILLEMENT OF ALL LAYOUT CONDITIONS,
AND ANY TRANSACTION PRIOR TO THE ABOVE IS ILLEGAL

EXTRACT OF SADASIVAPET MASTER PLAN
SITE UNDER REFERENCE

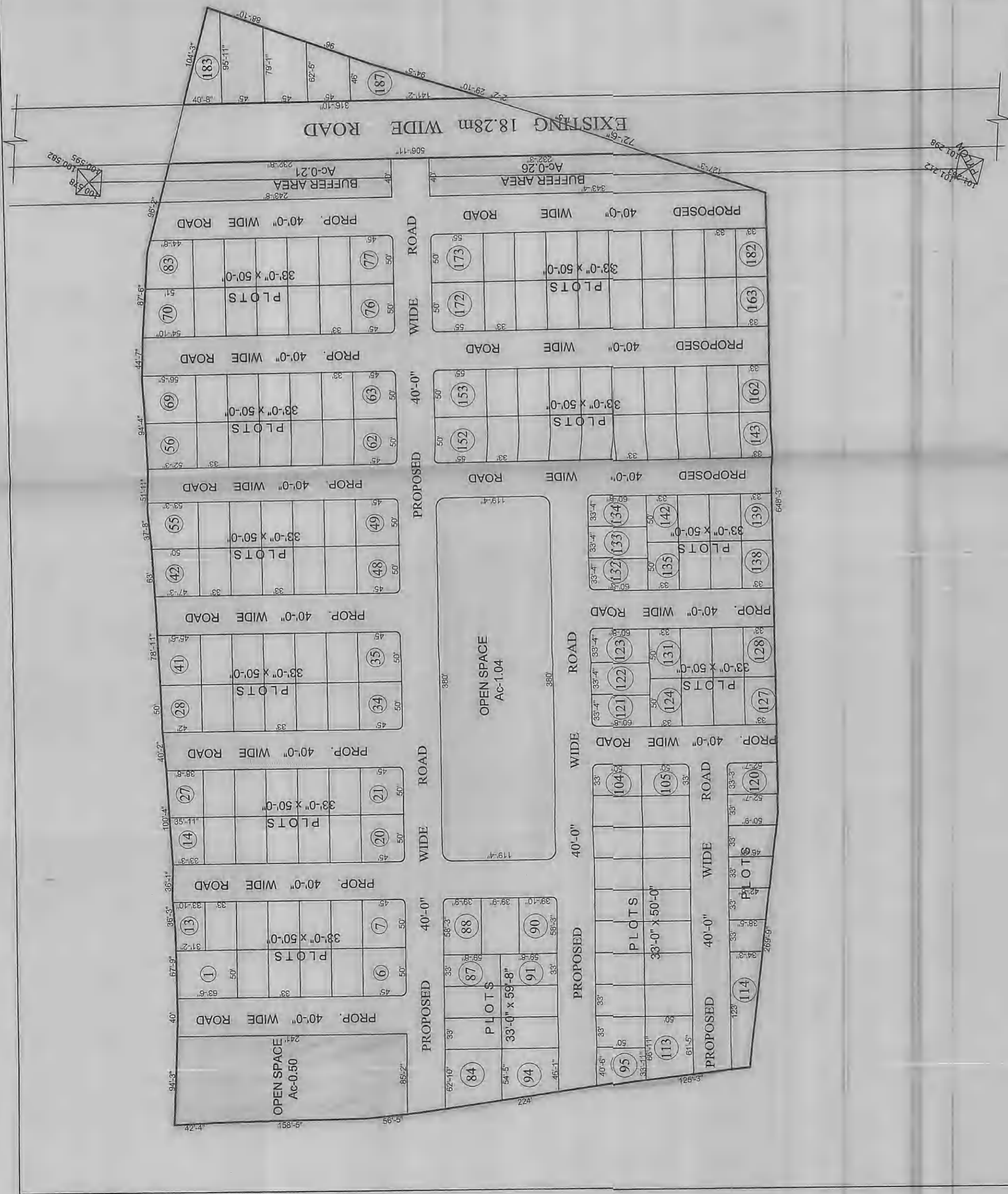
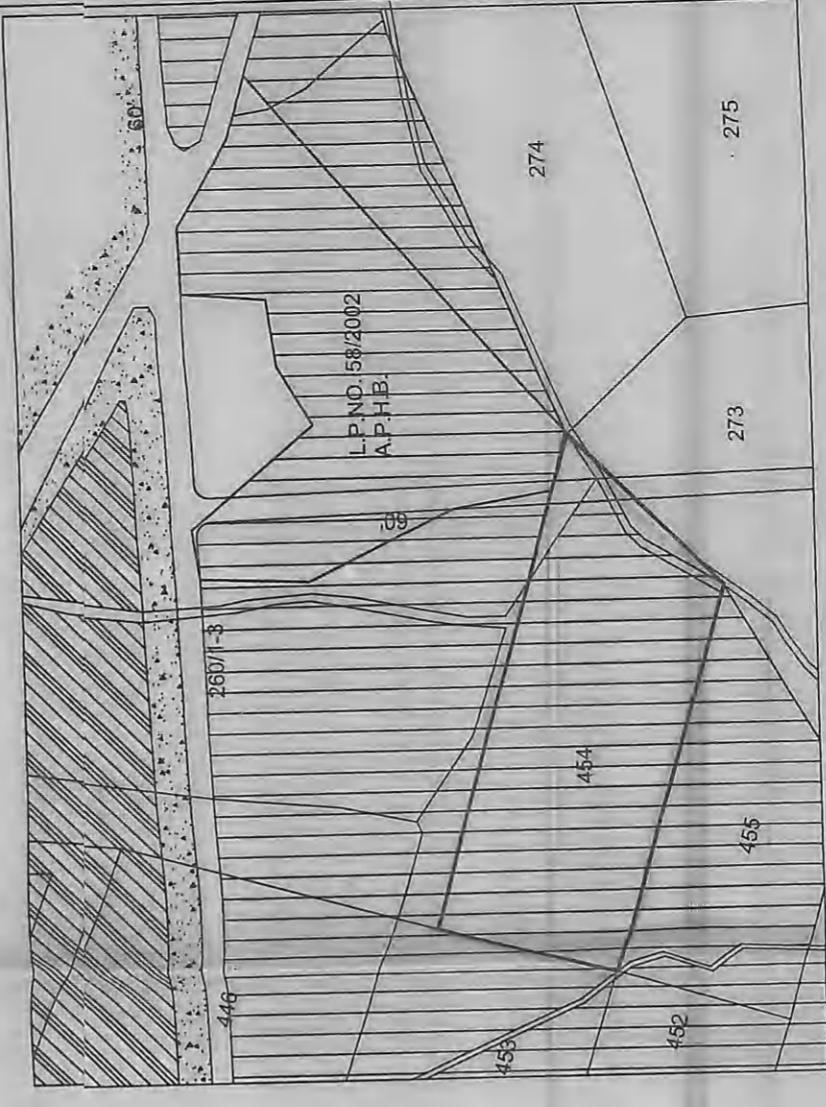

SADASIVAPET MUNICIPALITY
TECHNICAL LAYOUT PATTERN FOR RESIDENTIAL
PLOTS IN Sy.No. 454 AT SADASIVAPET MUNICIPALITY,
MEDAK DISTRICT.
SCALE : 1" = 100'-0"

REFERENCE :-
LAYOUT BOUNDARY
EXISTING ROADS
PROPOSED ROADS
TOTAL LAYOUT AREA : Ac. 15.40
SITE RESERVED FOR PUBLIC PURPOSE (PARK) (10.00%) : Ac. 1.54
ROADS AREA (31.42%) : Ac. 4.84
BUFFER AREA (3.11%) : Ac. 0.48
TOTAL NUMBER OF PLOTS : 187

P. Chandra
ASSIST. DIRECTOR
Amber
SURVEYOR

Sudheer
DEPUTY DIRECTOR

gud
JOINT DIRECTOR (RE)

lu
20/5/14
M.R.P., A.T.T.P., DIP. (HUSAG)
DIRECTOR OF TOWN AND COUNTRY PLANNING
GOVT. OF ANDHRA PRADESH