

C.NO. 2328 / 2014 / H

REF. No. G1/1704/MBNR/2014, DT. 23-05-2014 OF M.C.,  
MAHABUBNAGAR MUNICIPALITY.

CONFIRMED T.L.P. No. 02 / 2014 / H



CAUTION :-

THIS LAYOUT IS LEGALLY VALID ONLY ON ITS RELEASE/APPROVAL  
BY CONCERNED MUNICIPALITY UNDER SECTION 184 & 185 OF  
A.P.M.ACT.1985 ON FULL FILLMENT OF ALL LAYOUT CONDITIONS,  
AND ANY TRANSACTION PRIOR TO THE ABOVE IS ILLEGAL

EXTRACT OF MAHABUBNAGAR MASTER PLAN  
SITE U/R

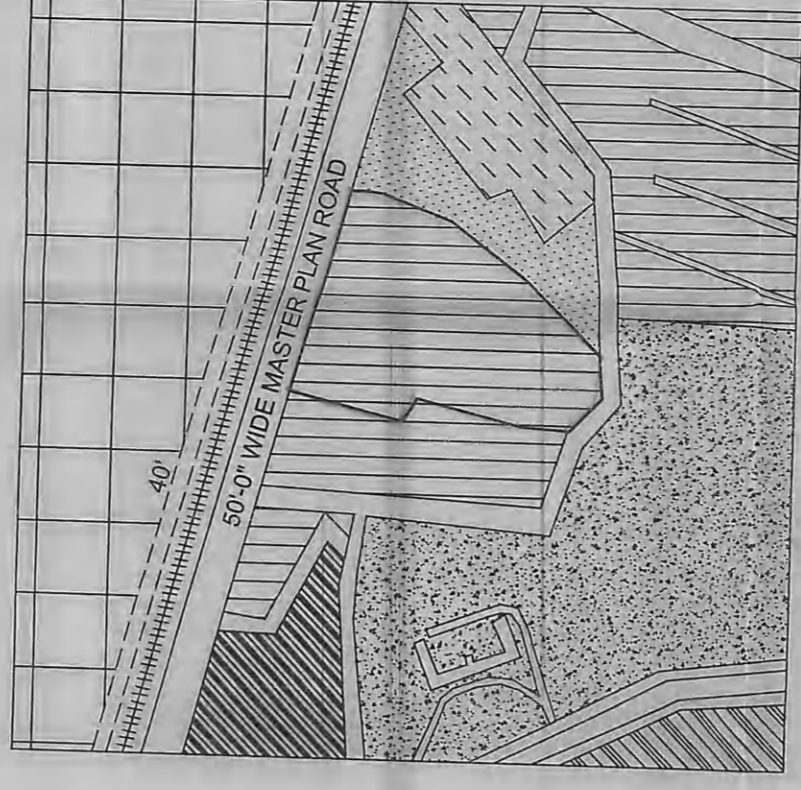

REFERENCE

LAYOUT BOUNDARY

EXISTING ROADS

PROPOSED ROADS

TOTAL LAYOUT AREA : AC. 7.05

SITE RESERVED FOR PUBLIC

PURPOSE (PARK) (10.00%) : AC. 0.70

ROADS AREA (36.73%) : AC. 2.59

TOTAL NUMBER OF PLOTS : 67



**MAHABUBNAGAR MUNICIPALITY**

TECHNICAL LAYOUT PATTERN FOR RESIDENTIAL PLOTS IN SY.NOS. 222,222/1,226  
227 & 228 OF YENUGONDA (V), MAHABUBNAGAR DISTRICT.

SCALE : - 1" = 66'-0"

ASST. DIRECTOR  
*Ambare*

SURVEYOR  
*R. Sai Devi*  
T.P.A. 3/1/2014

DEPUTY DIRECTOR

JOINT DIRECTOR

*N. Subbarao* 3/1/14  
DIRECTOR OF TOWN AND COUNTRY PLANNING  
GOVT. OF TELANGANA, HYDERABAD.