

C. NO:- 9372/2010/H
 CONFIRMED IN T.L.P.No:- 17/2011/H
 REF. NO:- G1/63/2007 OF M.C., SADASIVAPET

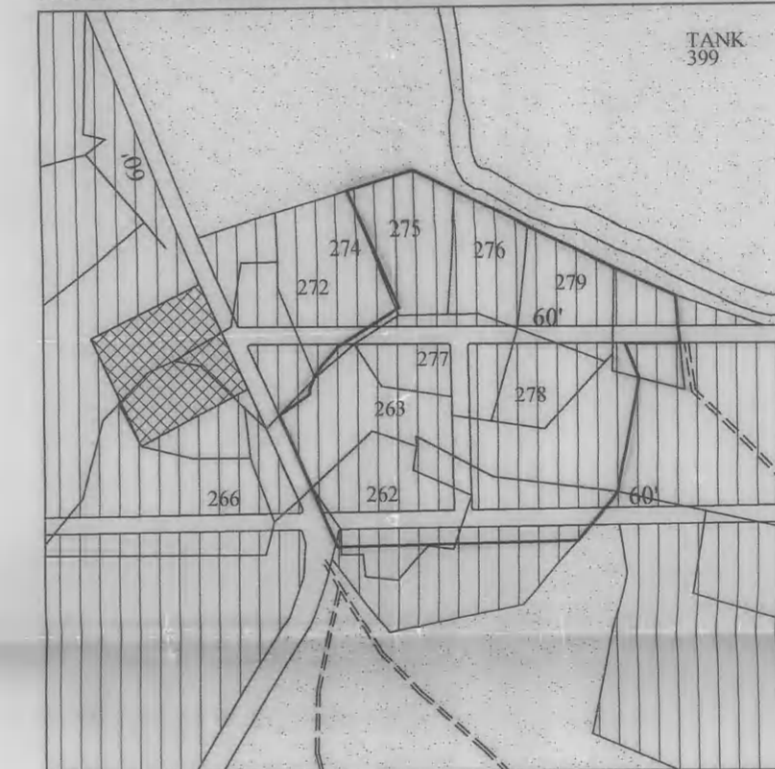

CAUTION:
 THIS LAYOUT IS LEGALLY VALID ONLY ON ITS
 RELEASE/ APPROVAL BY CONCERNED MUNICIPALITY
 UNDER SECTION 184 & 185 OF A.P.M. ACT 1965 AND ON
 FULFILLMENT OF ALL LAYOUT CONDITIONS. ANY
 TRANSACTION PRIOR TO THE ABOVE IS ILLEGAL.

SADASIVAPET TOWN
 EXTRACT OF G.T.P. SCHEME
 SCALE:- 660 FEET TO AN INCH
 SITE UNDER REFERENCE: [Symbol]



REFERENCE:

LAYOUT BOUNDARY	[Symbol]
EXISTING ROADS	[Symbol]
PROPOSED ROADS	[Symbol]
MASTER PLAN ROADS	[Symbol]
LAYOUT AREA	: Ac. 24.17
OPEN SPACE (10.0%)	: Ac. 2.42
ROADS AREA (34.80%)	: Ac. 8.41
No. OF PLOTS	229

NOTE:- THE MUNICIPAL COMMISSIONER, SHALL NOT RELEASE THE
 BUILDING PERMISSION IN PLOT No. 166 UNTIL & UNLESS A NOC
 FROM IRRIGATION DEPARTMENT AND ALSO FROM STRUCTURAL
 ENGINEER IS OBTAINED REGARDING THE FEASIBILITY OF THE
 STRUCTURE IN THE PLACE OF WELL(WHICH IS FILLED UP)



SADASIVAPET MUNICIPALITY
 TECHNICAL LAYOUT PATTERN FOR RESIDENTIAL PLOTS
 IN Sy.No's 261/P, 262/P, 263/P, 273, 275, 276, 277, 278 & 279
 SADASIVAPET TOWN, MEDAK DISTRICT.

SCALE :- 100 FEET TO AN INCH

ASSISTANT DIRECTOR	[Signature]	JOINT DIRECTOR (RE)
TOWN PLANNING ASSISTANT	[Signature]	
SUPERVISOR	[Signature]	DEPUTY DIRECTOR
M.A., M.R.P., A.I.T.P., C.D.P.(LONDON), DIRECTOR OF TOWN & COUNTRY PLANNING GOVT. OF A.P., HYDERABAD		