

C.No. 8554/2010/H
 CONFIRMED IN T.L.P.No. 15/2011/H
 Ref. No. G1/461/2010 OF M.C., KAMAREDDY,
 DT. 20-5-2010.

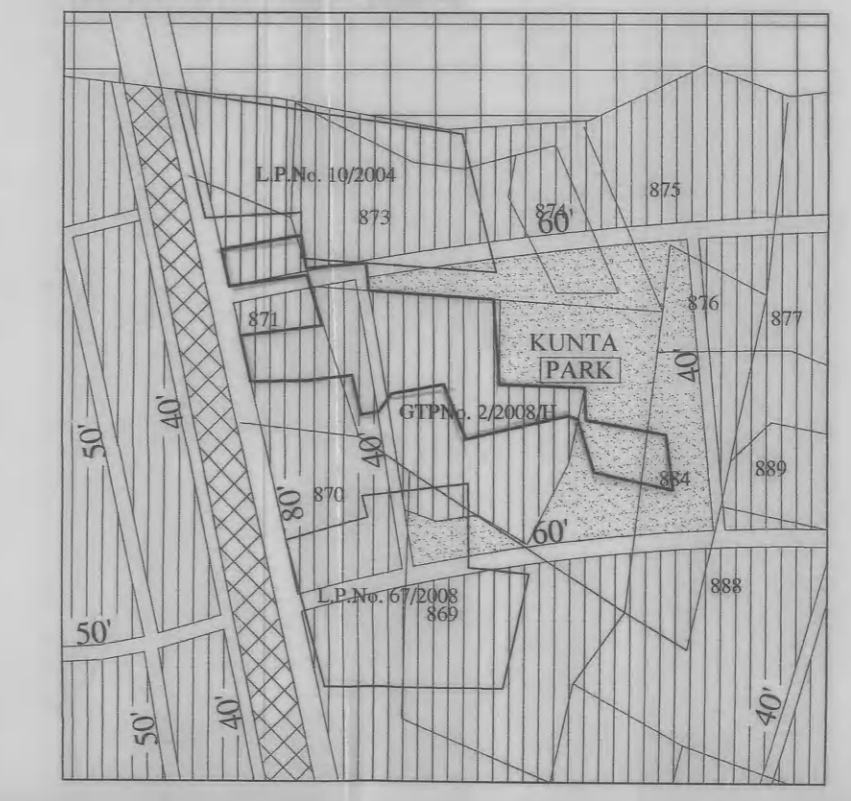

CAUTION:
 THIS LAYOUT IS LEGALLY VALID ONLY ON ITS RELEASE/
 APPROVAL BY CONCERNED MUNICIPALITY UNDER SECTION
 184 & 185 OF A.P.M. ACT. 1965 AND ON FULFILLMENT OF ALL
 LAYOUT CONDITIONS.
 ANY TRANSACTION PRIOR TO THE ABOVE IS ILLEGAL.

KAMAREDDY TOWN
 EXTRACT OF MASTER PLAN
 SCALE:- 1" = 660'-0"
 SITE UNDER REF:-



REFERENCE

LAYOUT BOUNDARY	
EXISTING ROADS	
PROPOSED ROADS	
MASTER PLAN ROADS	
LAYOUT AREA	AC 10.075
OPEN SPACE (10.00%)	AC 1.008
ROADS AREA (26.30%)	AC 2.65
No. OF PLOTS	117

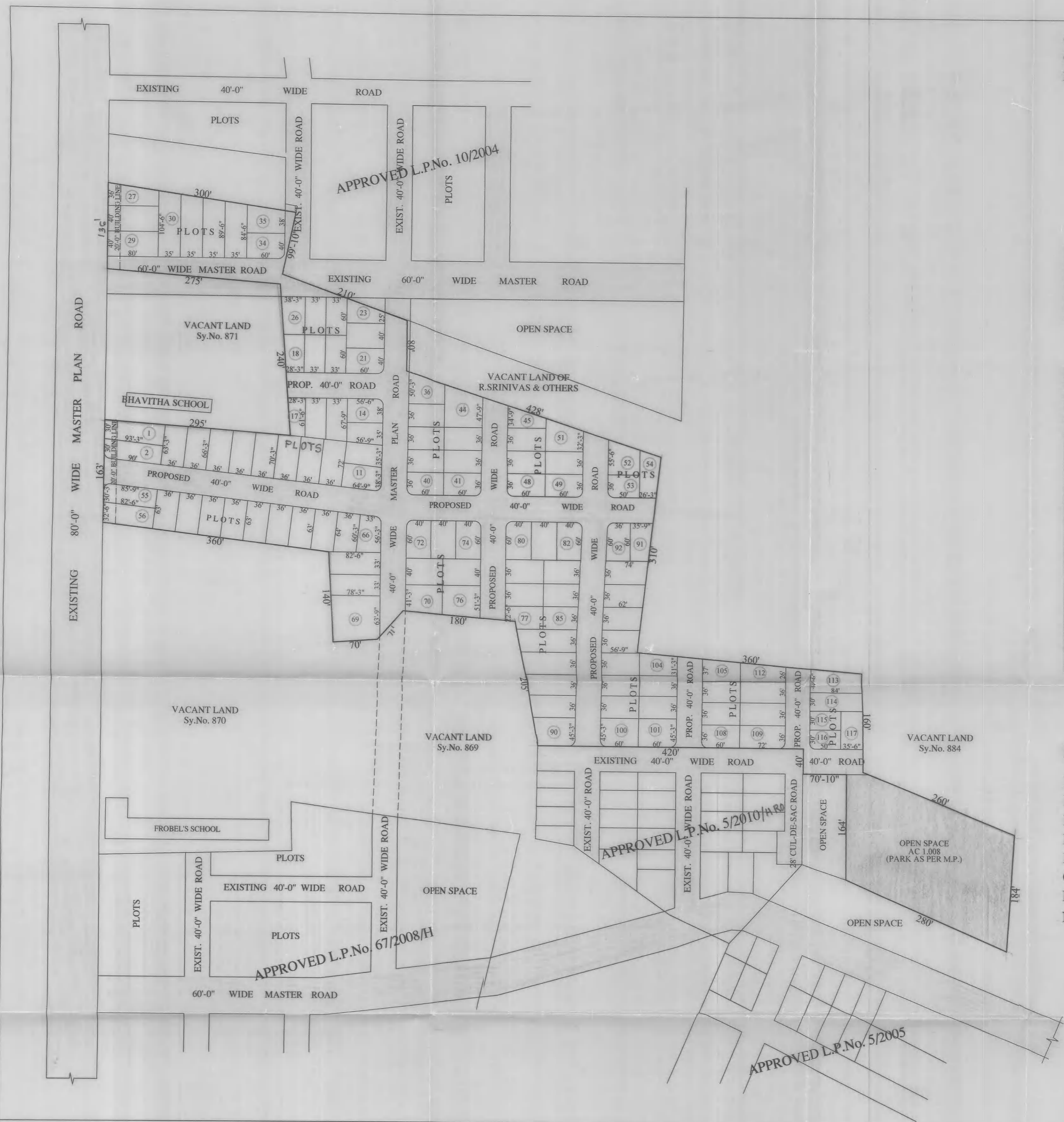

KAMAREDDY MUNICIPALITY
 TECHNICAL LAYOUT PATTERN FOR RESIDENTIAL PLOTS IN
 Sy. No. 871, 872/1 TO 8, 9B, 9C, 872/10 TO 15, 19 AND 884/2P SITUATED
 AT ADLOOR ROAD, KAMAREDDY. (FALLS IN SANC. MASTER PLAN OF KAMAREDDY)

SCALE: 100 FEET TO AN INCH

ASSISTANT DIRECTOR		JOINT DIRECTOR(RE)	
TOWN PLANNING ASSISTANT			
SUPERVISOR		DEPUTY DIRECTOR	

M.A. M.R.P. A.I.T.P. CIVIL ENGINEER
 DIRECTOR OF TOWN & COUNTRY PLANNING
 GOVERNMENT OF ANDHRA PRADESH, HYDERABAD.